

SIGN. & DATE

SUPERSEDES
INVENTORY NO.

COPYRIGHT AND CONFIDENTIAL

The information on this document is the property of Bharat Heavy Electricals Ltd.
It must not be used directly or indirectly in any way detrimental to the interest of the company

SIGN. & DATE

INVENTORY NO.

JT-05



TOOL STANDARD JIG AND TOOL ENGINEERING

TL 10131

Page 1 OF 1

TAPER BUSH

63 / THE REST

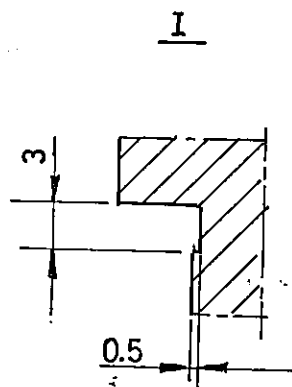
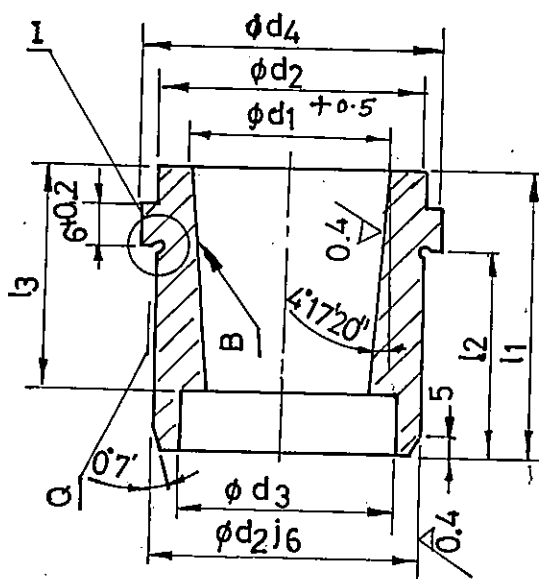

SL NO	CODE NO	$d_1^{+0.5}$	$d_2 \pm 0.012$ -0.007	d_3	d_4	l_1	l_2	l_3	WT.KG.
1	01	$30^{+0.5}$	$58^{+0.012}$ -0.007	35	68	55	44	37.5	0.75
2	02	$40^{+0.5}$	$70^{+0.012}$ -0.007	45	80	75	53	55.5	1.1
3	03	$50^{+0.5}$	$82^{+0.013}$ -0.009	55	92	86	53	65.5	2.0
4	04	$70^{+0.5}$	$104^{+0.013}$ -0.009	75	114	106	76	86	3.6
5	05	$100^{+0.5}$	$140^{+0.014}$ -0.011	105	150	136	100	121	5.1

1. MATERIAL 40Cr1 HW10571 / En 24 AA 10501 HARDEN TO HRC 40÷45 AS PER INST.0912.008

2. TAPER CONTACT SURFACE 'B' WITH GUIDE COLUMN TO BE
ACHIEVED 80% BY LAPPING.

3. SURFACE 'Q' TO BE GROUND IN ASSLY GUIDE COLUMN.

REVISION

(04)

THIS TL. SUPERSEDES U/SAME
TL. No. CHAD. No. JTE/D/99/027

WORKED BY

IP SINGH

-sd-

CHECKED BY

N SINGH

-sd-

APPROVED BY

MMA

sd/-

RETRACED FROM ORIGINAL

TRACED BEDD

CHD Singh 26.3.99